

GRACE VASO SOSPESO GRS02BI

CE EN 997:2015

GLOBO

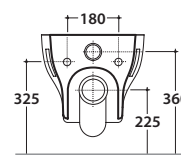
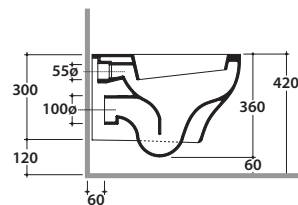
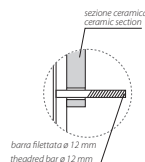
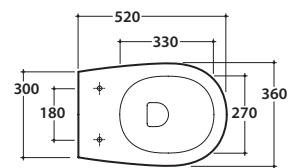

Scarico ottimizzato a 4/2,6 litri
Drain 4/2,6 lt

Cod. **GRS02BI**

Vaso sospeso 52.36 h36 cm. Scarico 4 / 2,6 Lt. Fissaggi non inclusi. Peso 25 Kg
Wall-hung Wc 52.36 h36 cm. Drain 4 / 2,6 Lt. Fixing kit not included. Weight 25 Kg

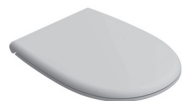

Coprivaso con sistema di cerniere a sgancio rapido
Seatcover with hinge system to quick release



Trattamento antibatterico per sedili in versione bianco lucido
Antibacterial treatment on toilet seats in shiny white

Cod. **GR021BI**

Coprivaso rimovibile in duroplast con chiusura tradizionale. Peso 2 Kg
Removable duroplast seat-cover with traditional closing system. Weight 2 Kg

Cod. **GR022BI**

Coprivaso rimovibile in duroplast con chiusura rallentata. Peso 2 Kg
Removable duroplast seat-cover with soft-closing system. Weight 2 Kg

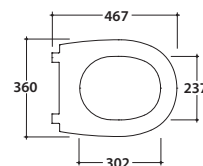
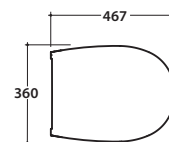

Cod. **VA132**

Riduttore flusso di scarico.
Flow reductor.



Cod. **PU001**

Protezione antiurto e acustica.
Acoustic and crash protection.



Cod. **FI002**

Staffa di fissaggio a "L". Peso 2,5 Kg
Fixing brackets for W/H sanitary. Weight 2,5 Kg